

Installation Manual

556200B

GR30-C-Series Guide Rail Systems

Models

GR30-C-Series 3" Pump Disconnect for Ordinary Locations

- For use with LGV/LGH03, LGV/LGH05, and LGV/LGH07-Series Grinder Pumps
- For use with LSGV/LSGH300 and LSGV/LSGH500-Series Grinder Pumps

Features

- Heavy-duty cast iron construction
- Accommodates single 1-1/4" guide pipe and 3" discharge pipe
- Auto-alignment feature
- Upper rail support bracket
- Includes sealing grommet

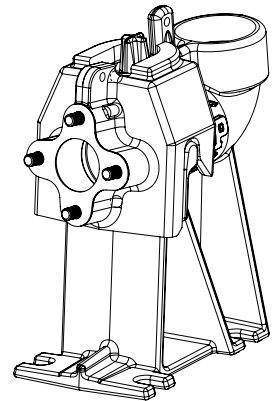
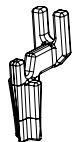

NOTICE

Installer: Manual must remain with owner/operator.

Record information:

7000 Apple Tree Avenue
Bergen, NY 14416
ph: 1-800-543-2550
fax: 1-585-494-1839
www.LibertyPumps.com

Keep this manual handy for future reference.
For replacement manual, visit LibertyPumps.com,
or contact Liberty Pumps at 1-800-543-2550.
Retain dated sales receipt for warranty.

Model: _____

Serial: _____

Mfg Date: _____

Install Date: _____

GR30-C-Series Assembly

The GR30-C-Series quick pump disconnect assembly is designed to allow easy installation and removal of the pump. When installed correctly, the guide rail assembly creates a tight discharge seal and provides a means to lift the pump without disconnecting any of the discharge piping. Ensure that installation is done per instructions.

The guide rail system consists of three parts: Upper Rail Support Bracket, Mounting Claw, and Base.

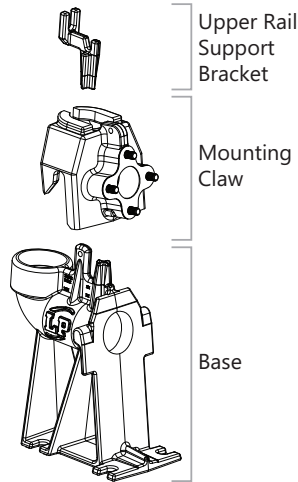

4. Insert upper rail support bracket into guide rail pipe. Place the upper rail support bracket at top of vault, mounting to secure vault structure. Once installed, tighten upper rail support top nuts.

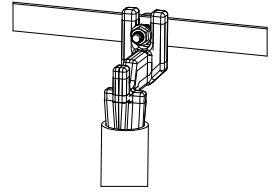

Pipe is not included; a heavy guide rail pipe of 1-1/4" galvanized or stainless steel is recommended.

Installation

1. Mount the base to the floor of the tank, referring to the **Base Mounting Template** measurements. Secure the base to the basin floor at the base slots with 1/2" bolts (stainless steel recommended). When mounting to a concrete surface, use 1/2" or 5/8" (14 or 16 mm) thread wedge anchors.

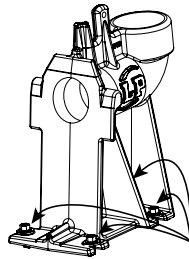

2. Using supplied bolts, mount the claw onto the pump discharge.

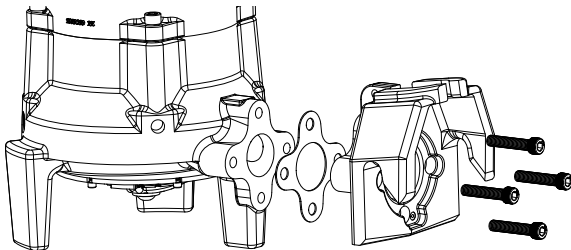

3. Insert grommet into mounting claw.

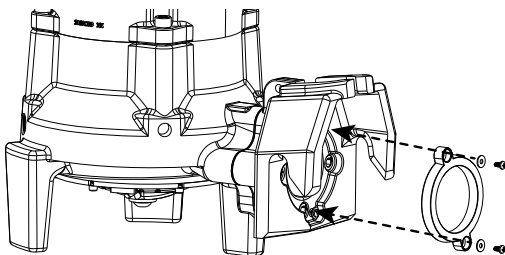

- a. Tighten until the washer does not spin freely. *Do not over-tighten.*
- b. Apply a light amount of sealing grease (provided) to the face of the grommet that sits on the guide rail base.

Operation

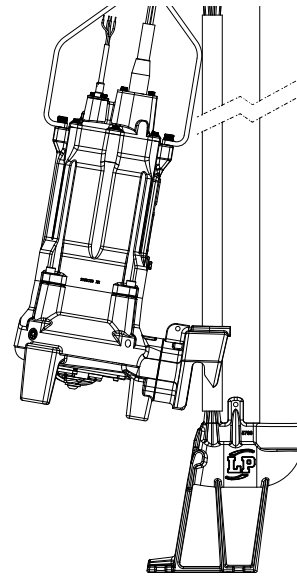

Disconnected view

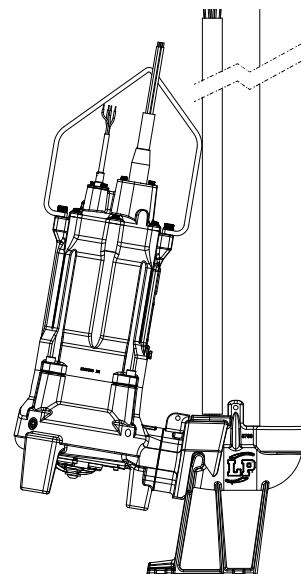

Connected view

This page intentionally left blank.

Esta página se dejó en blanco intencionalmente.

Cette page a été laissée vide intentionnellement.

Base Mounting Template

Plantilla de montaje de la base

Gabarit de montage de base

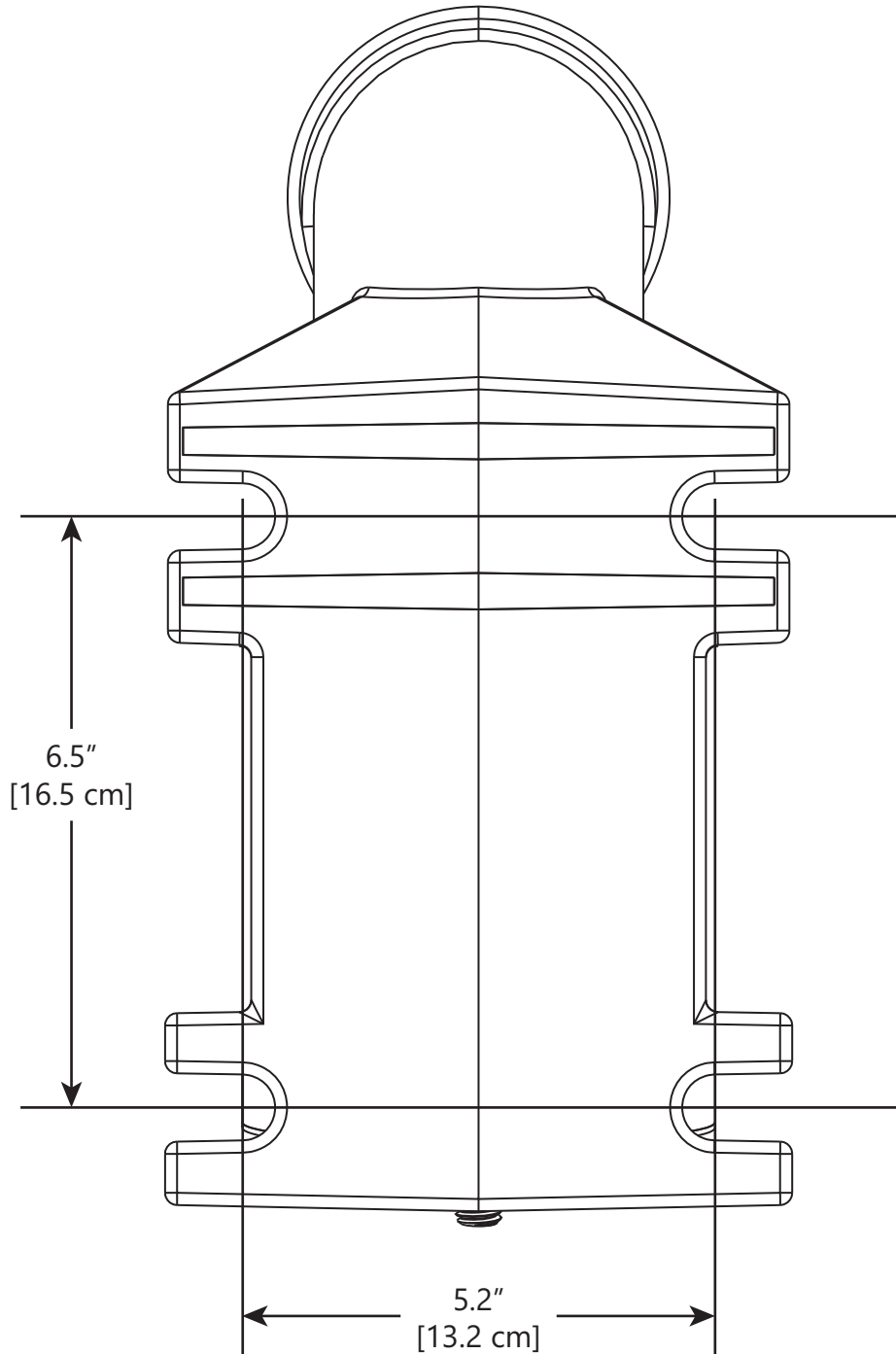

not to scale
no a escala
pas à l'échelle